

ELMHURST QUEENS BOULEVARD

LOCATION:

89-23 Queens Boulevard
Elmhurst, Queens, NY 11373

SIZE: GLA 4,477 Rentable square feet
89-23 Queens Blvd: Shophot 2,340 SF
89-25A Queens Blvd: Tea Do 972 SF
89-25B Queens Blvd: BoostMobile 1,165 SF
No Basement or Sprinkler System.
CALL FOR AVAILABILITIES



ZONING: C1-2 Overlay in R6.

PARKING: Metered Street Parking and Garages near by.

OTHER PROJECT TENANTS: Chase Bank

NEARBY TENANTS: On same block with White Castle and Bank of America. Between Queens Center Mall featuring JC Penny's, Macy's and many others and Queens Place featuring Target, Best Buy, DSW and others.

NEIGHBORHOOD: Densely populated middle income neighborhood, near Subway and Bus Lines. Tremendous Pedestrian and Vehicular Traffic.

PRICE: TBD RE Tax - \$26/sq ft, CAM & Insurance - \$5/sq ft.

NOTE: Excellent Queens Blvd location between two major Malls. Heavy Pedestrian Traffic!

2016	1/2 Mile	1 Mile	3 Mile
Estimated Population	42,719	188,378	915,149
Estimated Average HH Income	\$77,564	\$68,641	\$74,337



This property is offered subject to availability, errors, omissions, or changes in price or terms without notice. ID #2465

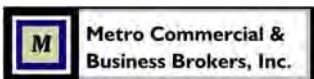

For more information and inspection, contact
Metro Commercial & Business Brokers, Inc.
425 Linda Drive, East Meadow, NY 11554
www.metrocbb.com



John R. Wilmarth
(516) 640-5440 john@metrocb.com

Gerry Dantone
(631) 623-6914 metrocb@aol.com

89-23 25 Queens Blvd, Elmhurst, Queens, NY 11373

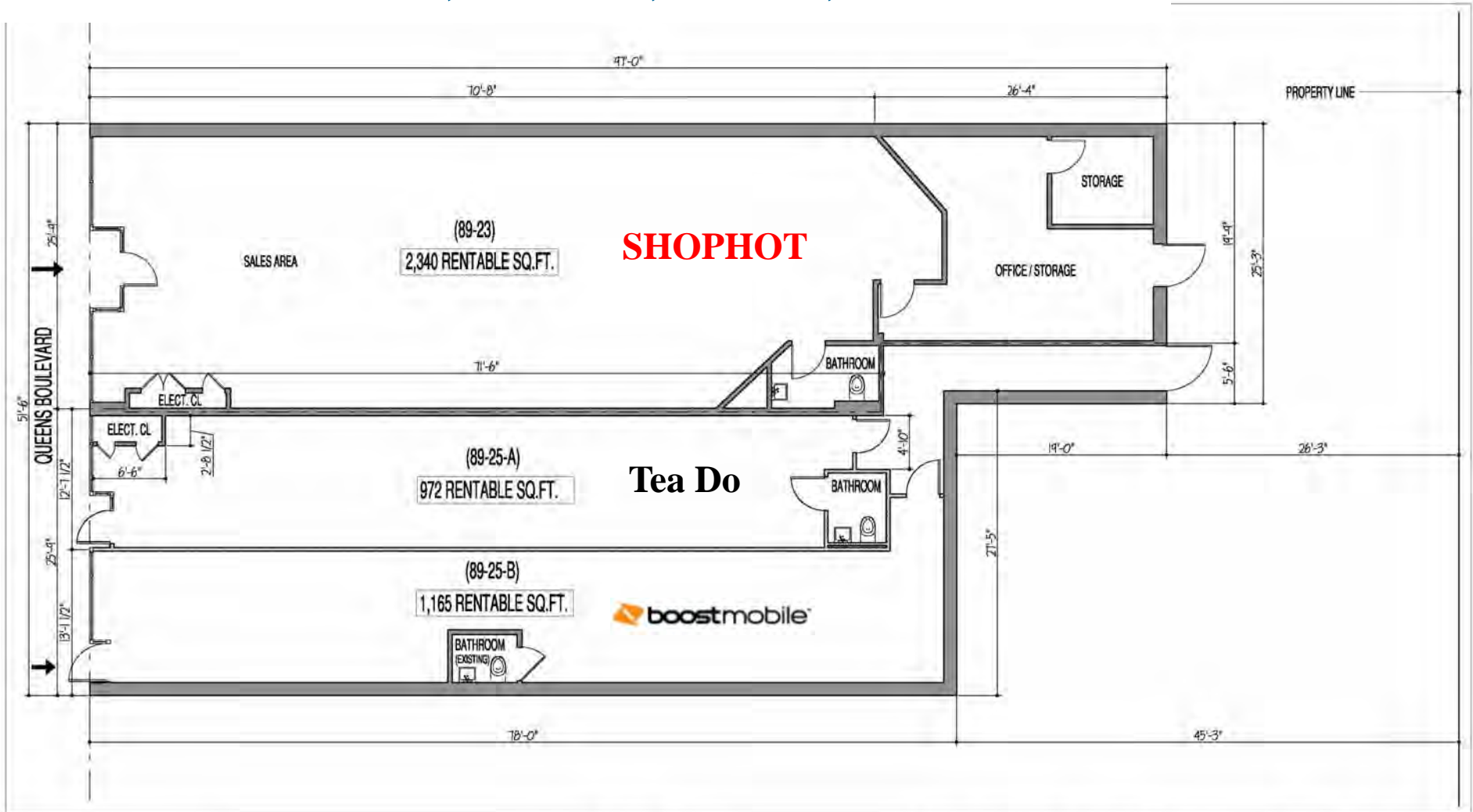

8923 & 8925 Queens Blvd.
Elmhurst, NY



**Metro Commercial &
Business Brokers, Inc.**

DRAWING TITLE
AS-BUILT PLANS
'QUEENS BOULEVARD'

For more information and inspection, contact
Metro Commercial & Business Brokers, Inc.
425 Linda Drive, East Meadow, NY 11554
www.metrocbb.com

John R. Wilmarth
(516) 640-5440 john@metrocb.com

Gerry Dantone
(631) 623-6914 metrocb@aol.com

JOB NUMBER 33069.00
DRAWN BY CL
SCALE 1/8"=1'-0"

DRAWING NO.

A.1



Member of
International Council
of Shopping Centers

**TULLER
McNEALUS
FELD**
ARCHITECTURE
INTERIOR DESIGN
54 West 38th Street
New York, NY 10018
Tel: (212) 768-7788
Fax: (212) 768-8171

89-23 Queens Blvd, Elmhurst, Queens, NY 11373



M Metro Commercial & Business Brokers, Inc.

For more information and inspection, contact
Metro Commercial & Business Brokers, Inc.
 425 Linda Drive, East Meadow, NY 11554

Member of
 International Council
 of Shopping Centers

www.metrocbb.com

John R. Wilmarth
 (516) 640-5440 john@metrocb.com

Gerry Dantone
 (631) 623-6914 metrocb@aol.com

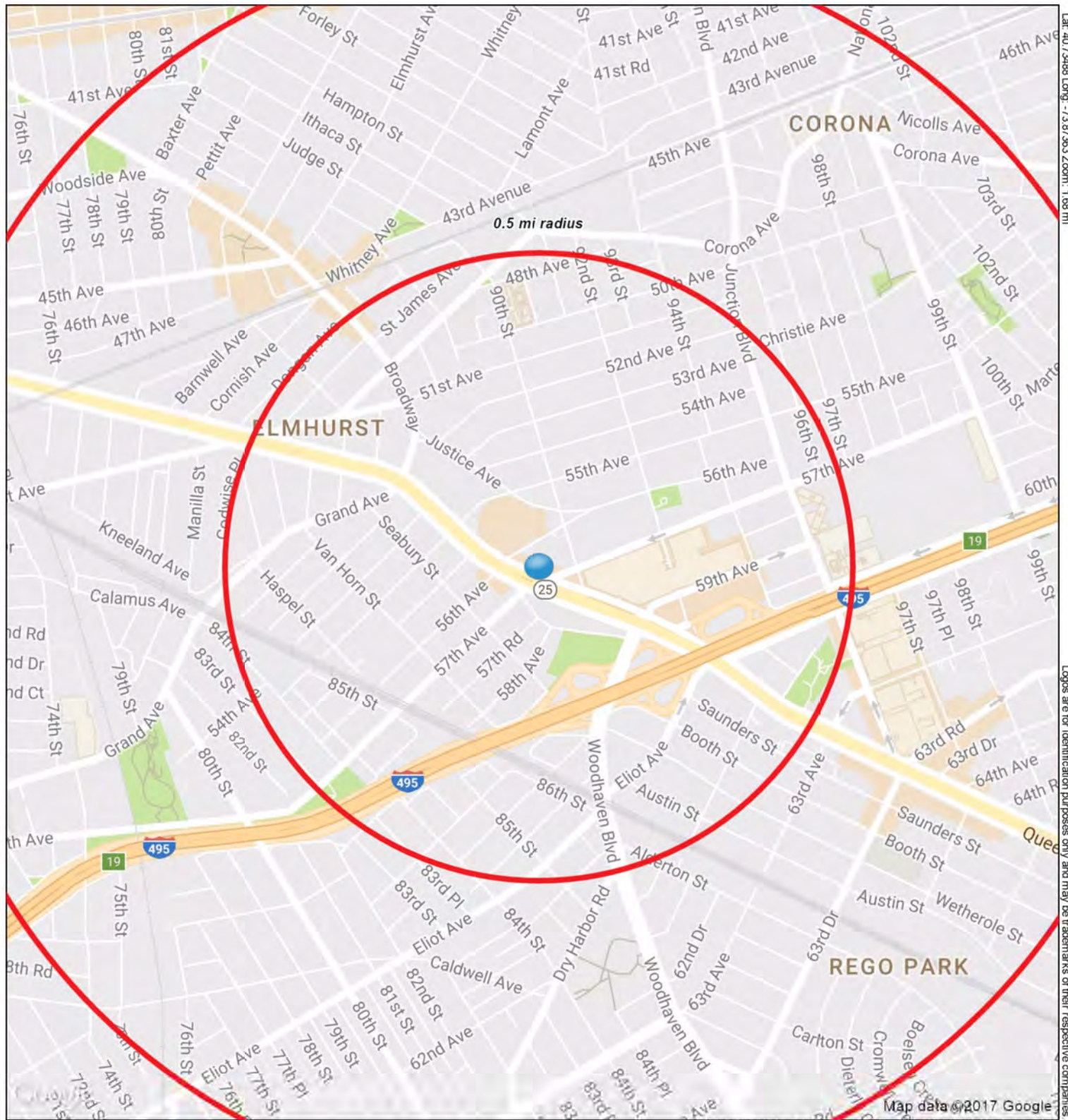

89-25 Queens Blvd

Elmhurst, NY 11373



**Metro Commercial &
Business Brokers, Inc.**

April 2017

Metro Commercial & Business Brokers, Inc.

COMPLETE PROFILE

2000-2010 Census, 2016 Estimates with 2021 Projections

Calculated using Weighted Block Centroid from Block Groups



Metro Commercial & Business Brokers, Inc.

Lat/Lon: 40.7348/-73.8734

RFULL9

89-25 Queens Blvd Elmhurst, NY 11373	0.5 mi radius		1 mi radius		2 mi radius		3 mi radius	
Population								
Estimated Population (2016)	42,719		188,378		555,256		915,149	
Projected Population (2021)	44,926		197,823		583,439		962,638	
Census Population (2010)	40,876		180,740		530,484		870,458	
Census Population (2000)	40,357		178,096		521,234		866,544	
Projected Annual Growth (2016-2021)	2,207	1.0%	9,445	1.0%	28,183	1.0%	47,489	1.0%
Historical Annual Growth (2010-2016)	1,843	0.8%	7,638	0.7%	24,772	0.8%	44,691	0.9%
Historical Annual Growth (2000-2010)	519	0.1%	2,644	0.1%	9,250	0.2%	3,914	-
Estimated Population Density (2016)	54,476 <i>psm</i>		59,987 <i>psm</i>		44,204 <i>psm</i>		32,379 <i>psm</i>	
Trade Area Size	0.8 <i>sq mi</i>		3.1 <i>sq mi</i>		12.6 <i>sq mi</i>		28.3 <i>sq mi</i>	
Households								
Estimated Households (2016)	14,465		63,266		188,355		323,428	
Projected Households (2021)	15,111		65,928		196,540		337,838	
Census Households (2010)	13,953		61,241		181,652		310,348	
Census Households (2000)	14,053		60,651		182,268		312,889	
Projected Annual Growth (2016-2021)	646	0.9%	2,662	0.8%	8,185	0.9%	14,410	0.9%
Historical Annual Change (2000-2016)	411	0.2%	2,615	0.3%	6,087	0.2%	10,538	0.2%
Average Household Income								
Estimated Average Household Income (2016)	\$77,564		\$68,641		\$73,341		\$74,337	
Projected Average Household Income (2021)	\$92,006		\$79,647		\$85,761		\$86,972	
Census Average Household Income (2010)	\$65,759		\$59,591		\$64,235		\$64,424	
Census Average Household Income (2000)	\$50,127		\$48,427		\$51,434		\$51,087	
Projected Annual Change (2016-2021)	\$14,442	3.7%	\$11,006	3.2%	\$12,420	3.4%	\$12,635	3.4%
Historical Annual Change (2000-2016)	\$27,437	3.4%	\$20,214	2.6%	\$21,907	2.7%	\$23,250	2.8%
Median Household Income								
Estimated Median Household Income (2016)	\$57,897		\$54,127		\$57,956		\$59,095	
Projected Median Household Income (2021)	\$63,227		\$59,423		\$63,728		\$64,943	
Census Median Household Income (2010)	\$52,526		\$48,365		\$52,458		\$52,862	
Census Median Household Income (2000)	\$39,964		\$38,767		\$41,590		\$41,521	
Projected Annual Change (2016-2021)	\$5,330	1.8%	\$5,296	2.0%	\$5,773	2.0%	\$5,848	2.0%
Historical Annual Change (2000-2016)	\$17,933	2.8%	\$15,360	2.5%	\$16,366	2.5%	\$17,574	2.6%
Per Capita Income								
Estimated Per Capita Income (2016)	\$26,274		\$23,067		\$24,912		\$26,306	
Projected Per Capita Income (2021)	\$30,957		\$26,557		\$28,922		\$30,555	
Census Per Capita Income (2010)	\$22,446		\$20,192		\$21,996		\$22,969	
Census Per Capita Income (2000)	\$17,146		\$16,382		\$17,917		\$18,353	
Projected Annual Change (2016-2021)	\$4,683	3.6%	\$3,490	3.0%	\$4,009	3.2%	\$4,249	3.2%
Historical Annual Change (2000-2016)	\$9,128	3.3%	\$6,685	2.6%	\$6,996	2.4%	\$7,953	2.7%
Estimated Average Household Net Worth (2016)	\$693,989		\$606,686		\$667,699		\$684,707	

This report was produced using data from private and government sources deemed to be reliable. The information herein is provided without representation or warranty.

COMPLETE PROFILE

2000-2010 Census, 2016 Estimates with 2021 Projections

Calculated using Weighted Block Centroid from Block Groups



Metro Commercial & Business Brokers, Inc.

Lat/Lon: 40.7348/-73.8734

RFULL9

89-25 Queens Blvd Elmhurst, NY 11373	0.5 mi radius		1 mi radius		2 mi radius		3 mi radius	
Race and Ethnicity								
Total Population (2016)	42,719		188,378		555,256		915,149	
White (2016)	11,058	25.9%	65,922	35.0%	230,367	41.5%	409,736	44.8%
Black or African American (2016)	2,258	5.3%	13,874	7.4%	36,449	6.6%	60,488	6.6%
American Indian or Alaska Native (2016)	218	0.5%	1,102	0.6%	3,788	0.7%	5,595	0.6%
Asian (2016)	23,736	55.6%	72,017	38.2%	161,407	29.1%	258,657	28.3%
Hawaiian or Pacific Islander (2016)	20	-	79	-	224	-	371	-
Other Race (2016)	4,149	9.7%	28,302	15.0%	100,890	18.2%	145,223	15.9%
Two or More Races (2016)	1,280	3.0%	7,082	3.8%	22,131	4.0%	35,079	3.8%
Population < 18 (2016)	7,716	18.1%	37,171	19.7%	111,849	20.1%	181,743	19.9%
White Not Hispanic	764	9.9%	5,807	15.6%	21,628	19.3%	41,994	23.1%
Black or African American	413	5.4%	2,455	6.6%	6,041	5.4%	10,484	5.8%
Asian	4,006	51.9%	12,711	34.2%	29,116	26.0%	46,004	25.3%
Other Race Not Hispanic	159	2.1%	735	2.0%	2,220	2.0%	3,911	2.2%
Hispanic	2,374	30.8%	15,462	41.6%	52,844	47.2%	79,350	43.7%
Not Hispanic or Latino Population (2016)	31,584	73.9%	120,404	63.9%	324,601	58.5%	572,060	62.5%
Not Hispanic White	5,529	17.5%	34,635	28.8%	127,386	39.2%	254,588	44.5%
Not Hispanic Black or African American	1,892	6.0%	11,047	9.2%	27,310	8.4%	44,845	7.8%
Not Hispanic American Indian or Alaska Native	69	0.2%	264	0.2%	675	0.2%	1,150	0.2%
Not Hispanic Asian	23,174	73.4%	70,625	58.7%	158,351	48.8%	253,357	44.3%
Not Hispanic Hawaiian or Pacific Islander	15	-	48	-	101	-	184	-
Not Hispanic Other Race	241	0.8%	1,067	0.9%	3,449	1.1%	5,164	0.9%
Not Hispanic Two or More Races	664	2.1%	2,719	2.3%	7,328	2.3%	12,773	2.2%
Hispanic or Latino Population (2016)	11,135	26.1%	67,974	36.1%	230,655	41.5%	343,089	37.5%
Hispanic White	5,529	49.7%	31,287	46.0%	102,981	44.6%	155,148	45.2%
Hispanic Black or African American	366	3.3%	2,827	4.2%	9,138	4.0%	15,643	4.6%
Hispanic American Indian or Alaska Native	149	1.3%	838	1.2%	3,113	1.3%	4,446	1.3%
Hispanic Asian	562	5.0%	1,393	2.0%	3,056	1.3%	5,301	1.5%
Hispanic Hawaiian or Pacific Islander	5	-	32	-	123	0.1%	187	0.1%
Hispanic Other Race	3,908	35.1%	27,235	40.1%	97,440	42.2%	140,059	40.8%
Hispanic Two or More Races	617	5.5%	4,363	6.4%	14,804	6.4%	22,305	6.5%
Not Hispanic or Latino Population (2010)	29,240	71.5%	111,368	61.6%	298,234	56.2%	530,068	60.9%
Hispanic or Latino Population (2010)	11,636	28.5%	69,372	38.4%	232,250	43.8%	340,390	39.1%
Not Hispanic or Latino Population (2000)	28,749	71.2%	113,164	63.5%	315,228	60.5%	559,540	64.6%
Hispanic or Latino Population (2000)	11,608	28.8%	64,933	36.5%	206,007	39.5%	307,004	35.4%
Not Hispanic or Latino Population (2021)	33,186	73.9%	126,037	63.7%	339,068	58.1%	595,421	61.9%
Hispanic or Latino Population (2021)	11,739	26.1%	71,786	36.3%	244,371	41.9%	367,217	38.1%
Projected Annual Growth (2016-2021)	605	1.1%	3,811	1.1%	13,716	1.2%	24,128	1.4%
Historical Annual Growth (2000-2010)	28	-	4,439	0.7%	26,243	1.3%	33,386	1.1%

This report was produced using data from private and government sources deemed to be reliable. The information herein is provided without representation or warranty.

COMPLETE PROFILE

2000-2010 Census, 2016 Estimates with 2021 Projections

Calculated using Weighted Block Centroid from Block Groups



Metro Commercial & Business Brokers, Inc.

Lat/Lon: 40.7348/-73.8734

RFULL9

89-25 Queens Blvd

Elmhurst, NY 11373

Total Age Distribution (2016)

	0.5 mi radius		1 mi radius		2 mi radius		3 mi radius	
Total Population	42,719		188,378		555,256		915,149	
Age Under 5 Years	2,475	5.8%	12,188	6.5%	37,493	6.8%	60,241	6.6%
Age 5 to 9 Years	2,125	5.0%	10,418	5.5%	31,385	5.7%	50,674	5.5%
Age 10 to 14 Years	1,976	4.6%	9,290	4.9%	27,553	5.0%	45,408	5.0%
Age 15 to 19 Years	1,955	4.6%	9,125	4.8%	26,773	4.8%	44,210	4.8%
Age 20 to 24 Years	2,774	6.5%	12,237	6.5%	35,666	6.4%	58,259	6.4%
Age 25 to 29 Years	3,869	9.1%	16,095	8.5%	47,105	8.5%	78,522	8.6%
Age 30 to 34 Years	3,576	8.4%	15,540	8.2%	47,956	8.6%	80,090	8.8%
Age 35 to 39 Years	3,192	7.5%	14,500	7.7%	44,753	8.1%	73,692	8.1%
Age 40 to 44 Years	2,964	6.9%	13,166	7.0%	39,743	7.2%	65,905	7.2%
Age 45 to 49 Years	3,030	7.1%	12,883	6.8%	37,576	6.8%	62,281	6.8%
Age 50 to 54 Years	2,997	7.0%	12,824	6.8%	36,807	6.6%	61,127	6.7%
Age 55 to 59 Years	3,086	7.2%	12,709	6.7%	35,702	6.4%	59,044	6.5%
Age 60 to 64 Years	2,617	6.1%	11,146	5.9%	30,995	5.6%	51,174	5.6%
Age 65 to 69 Years	1,980	4.6%	8,535	4.5%	24,670	4.4%	40,720	4.4%
Age 70 to 74 Years	1,486	3.5%	6,458	3.4%	17,937	3.2%	29,442	3.2%
Age 75 to 79 Years	1,069	2.5%	4,603	2.4%	13,060	2.4%	21,630	2.4%
Age 80 to 84 Years	810	1.9%	3,213	1.7%	9,244	1.7%	15,042	1.6%
Age 85 Years or Over	738	1.7%	3,447	1.8%	10,837	2.0%	17,689	1.9%
Median Age	38.3		37.6		37.1		37.1	
Age 19 Years or Less	8,530	20.0%	41,021	21.8%	123,203	22.2%	200,532	21.9%
Age 20 to 64 Years	28,106	65.8%	121,101	64.3%	356,304	64.2%	590,095	64.5%
Age 65 Years or Over	6,083	14.2%	26,256	13.9%	75,749	13.6%	124,522	13.6%

Female Age Distribution (2016)

Female Population	22,023	51.6%	94,997	50.4%	276,433	49.8%	460,374	50.3%
Age Under 5 Years	1,191	5.4%	5,805	6.1%	17,989	6.5%	29,040	6.3%
Age 5 to 9 Years	1,030	4.7%	4,950	5.2%	15,018	5.4%	24,289	5.3%
Age 10 to 14 Years	966	4.4%	4,513	4.8%	13,356	4.8%	21,897	4.8%
Age 15 to 19 Years	963	4.4%	4,304	4.5%	12,506	4.5%	20,852	4.5%
Age 20 to 24 Years	1,365	6.2%	5,661	6.0%	16,263	5.9%	27,526	6.0%
Age 25 to 29 Years	1,950	8.9%	7,873	8.3%	22,492	8.1%	38,634	8.4%
Age 30 to 34 Years	1,840	8.4%	7,575	8.0%	22,768	8.2%	38,686	8.4%
Age 35 to 39 Years	1,532	7.0%	6,933	7.3%	20,955	7.6%	35,032	7.6%
Age 40 to 44 Years	1,503	6.8%	6,340	6.7%	18,577	6.7%	31,444	6.8%
Age 45 to 49 Years	1,552	7.0%	6,333	6.7%	18,179	6.6%	30,488	6.6%
Age 50 to 54 Years	1,585	7.2%	6,612	7.0%	18,662	6.8%	31,139	6.8%
Age 55 to 59 Years	1,650	7.5%	6,803	7.2%	18,694	6.8%	30,888	6.7%
Age 60 to 64 Years	1,393	6.3%	5,990	6.3%	16,764	6.1%	27,641	6.0%
Age 65 to 69 Years	1,098	5.0%	4,721	5.0%	13,571	4.9%	22,365	4.9%
Age 70 to 74 Years	835	3.8%	3,593	3.8%	10,009	3.6%	16,529	3.6%
Age 75 to 79 Years	610	2.8%	2,692	2.8%	7,594	2.7%	12,550	2.7%
Age 80 to 84 Years	483	2.2%	1,960	2.1%	5,695	2.1%	9,403	2.0%
Age 85 Years or Over	478	2.2%	2,338	2.5%	7,341	2.7%	11,970	2.6%
Female Median Age	39.7		39.4		38.7		38.6	
Age 19 Years or Less	4,149	18.8%	19,573	20.6%	58,869	21.3%	96,078	20.9%
Age 20 to 64 Years	14,370	65.3%	60,120	63.3%	173,354	62.7%	291,478	63.3%
Age 65 Years or Over	3,504	15.9%	15,305	16.1%	44,211	16.0%	72,818	15.8%

This report was produced using data from private and government sources deemed to be reliable. The information herein is provided without representation or warranty.

COMPLETE PROFILE

2000-2010 Census, 2016 Estimates with 2021 Projections

Calculated using Weighted Block Centroid from Block Groups



Metro Commercial & Business Brokers, Inc.

Lat/Lon: 40.7348/-73.8734

RFULL9

89-25 Queens Blvd

Elmhurst, NY 11373

0.5 mi radius 1 mi radius 2 mi radius 3 mi radius

Male Age Distribution (2016)

Male Population	20,696	48.4%	93,380	49.6%	278,823	50.2%	454,775	49.7%
Age Under 5 Years	1,284	6.2%	6,382	6.8%	19,504	7.0%	31,201	6.9%
Age 5 to 9 Years	1,095	5.3%	5,468	5.9%	16,366	5.9%	26,385	5.8%
Age 10 to 14 Years	1,010	4.9%	4,777	5.1%	14,198	5.1%	23,511	5.2%
Age 15 to 19 Years	992	4.8%	4,821	5.2%	14,267	5.1%	23,358	5.1%
Age 20 to 24 Years	1,409	6.8%	6,577	7.0%	19,403	7.0%	30,734	6.8%
Age 25 to 29 Years	1,919	9.3%	8,223	8.8%	24,613	8.8%	39,888	8.8%
Age 30 to 34 Years	1,736	8.4%	7,965	8.5%	25,188	9.0%	41,403	9.1%
Age 35 to 39 Years	1,660	8.0%	7,567	8.1%	23,798	8.5%	38,661	8.5%
Age 40 to 44 Years	1,462	7.1%	6,826	7.3%	21,165	7.6%	34,461	7.6%
Age 45 to 49 Years	1,478	7.1%	6,550	7.0%	19,397	7.0%	31,793	7.0%
Age 50 to 54 Years	1,412	6.8%	6,212	6.7%	18,145	6.5%	29,987	6.6%
Age 55 to 59 Years	1,436	6.9%	5,906	6.3%	17,008	6.1%	28,156	6.2%
Age 60 to 64 Years	1,224	5.9%	5,156	5.5%	14,231	5.1%	23,533	5.2%
Age 65 to 69 Years	883	4.3%	3,813	4.1%	11,099	4.0%	18,355	4.0%
Age 70 to 74 Years	651	3.1%	2,865	3.1%	7,929	2.8%	12,912	2.8%
Age 75 to 79 Years	459	2.2%	1,911	2.0%	5,466	2.0%	9,079	2.0%
Age 80 to 84 Years	327	1.6%	1,253	1.3%	3,549	1.3%	5,639	1.2%
Age 85 Years or Over	260	1.3%	1,109	1.2%	3,496	1.3%	5,719	1.3%
Male Median Age	36.9		36.0		35.6		35.7	
Age 19 Years or Less	4,381	21.2%	21,448	23.0%	64,335	23.1%	104,454	23.0%
Age 20 to 64 Years	13,736	66.4%	60,981	65.3%	182,950	65.6%	298,617	65.7%
Age 65 Years or Over	2,579	12.5%	10,951	11.7%	31,538	11.3%	51,704	11.4%

Males per 100 Females (2016)

Overall Comparison	94		98		101		99	
Age Under 5 Years	108	51.9%	110	52.4%	108	52.0%	107	51.8%
Age 5 to 9 Years	106	51.5%	110	52.5%	109	52.1%	109	52.1%
Age 10 to 14 Years	105	51.1%	106	51.4%	106	51.5%	107	51.8%
Age 15 to 19 Years	103	50.7%	112	52.8%	114	53.3%	112	52.8%
Age 20 to 24 Years	103	50.8%	116	53.7%	119	54.4%	112	52.8%
Age 25 to 29 Years	98	49.6%	104	51.1%	109	52.3%	103	50.8%
Age 30 to 34 Years	94	48.6%	105	51.3%	111	52.5%	107	51.7%
Age 35 to 39 Years	108	52.0%	109	52.2%	114	53.2%	110	52.5%
Age 40 to 44 Years	97	49.3%	108	51.8%	114	53.3%	110	52.3%
Age 45 to 49 Years	95	48.8%	103	50.8%	107	51.6%	104	51.0%
Age 50 to 54 Years	89	47.1%	94	48.4%	97	49.3%	96	49.1%
Age 55 to 59 Years	87	46.5%	87	46.5%	91	47.6%	91	47.7%
Age 60 to 64 Years	88	46.8%	86	46.3%	85	45.9%	85	46.0%
Age 65 to 69 Years	80	44.6%	81	44.7%	82	45.0%	82	45.1%
Age 70 to 74 Years	78	43.8%	80	44.4%	79	44.2%	78	43.9%
Age 75 to 79 Years	75	42.9%	71	41.5%	72	41.9%	72	42.0%
Age 80 to 84 Years	68	40.4%	64	39.0%	62	38.4%	60	37.5%
Age 85 Years or Over	54	35.2%	47	32.2%	48	32.3%	48	32.3%
Age 19 Years or Less	106	51.4%	110	52.3%	109	52.2%	109	52.1%
Age 20 to 39 Years	101	50.1%	108	52.0%	113	53.0%	108	51.9%
Age 40 to 64 Years	91	47.7%	96	48.9%	99	49.7%	98	49.4%
Age 65 Years or Over	74	42.4%	72	41.7%	71	41.6%	71	41.5%

This report was produced using data from private and government sources deemed to be reliable. The information herein is provided without representation or warranty.

COMPLETE PROFILE

2000-2010 Census, 2016 Estimates with 2021 Projections

Calculated using Weighted Block Centroid from Block Groups



Metro Commercial & Business Brokers, Inc.

Lat/Lon: 40.7348/-73.8734

RFULL9

89-25 Queens Blvd

Elmhurst, NY 11373

	0.5 mi radius	1 mi radius	2 mi radius	3 mi radius
Household Type (2016)				
Total Households	14,465	63,266	188,355	323,428
Households with Children	4,534 31.3%	21,029 33.2%	62,180 33.0%	101,577 31.4%
Average Household Size	2.9	3.0	2.9	2.8
Household Density per Square Mile	18,445	20,147	14,995	11,443
Population Family	36,565 85.6%	161,186 85.6%	468,676 84.4%	759,883 83.0%
Population Non-Family	6,105 14.3%	26,675 14.2%	83,694 15.1%	150,224 16.4%
Population Group Quarters	49 0.1%	517 0.3%	2,886 0.5%	5,042 0.6%
Family Households	10,201 70.5%	44,036 69.6%	127,740 67.8%	213,491 66.0%
Married Couple Households	7,088 69.5%	29,560 67.1%	86,373 67.6%	145,389 68.1%
Other Family Households	3,113 30.5%	14,476 32.9%	41,367 32.4%	68,101 31.9%
Family Households with Children	4,496 44.1%	20,820 47.3%	61,550 48.2%	100,693 47.2%
Married Couple with Children	3,226 71.8%	14,317 68.8%	42,316 68.8%	69,356 68.9%
Other Family Households with Children	1,270 28.2%	6,503 31.2%	19,234 31.2%	31,337 31.1%
Family Households No Children	5,705 55.9%	23,216 52.7%	66,190 51.8%	112,797 52.8%
Married Couple No Children	3,862 67.7%	15,244 65.7%	44,057 66.6%	76,033 67.4%
Other Family Households No Children	1,843 32.3%	7,973 34.3%	22,133 33.4%	36,764 32.6%
Non-Family Households	4,263 29.5%	19,230 30.4%	60,615 32.2%	109,937 34.0%
Non-Family Households with Children	38 0.9%	209 1.1%	630 1.0%	883 0.8%
Non-Family Households No Children	4,226 99.1%	19,021 98.9%	59,985 99.0%	109,054 99.2%
Average Family Household Size	3.6	3.7	3.7	3.6
Average Family Income	\$88,858	\$78,033	\$82,172	\$83,438
Median Family Income	\$67,554	\$63,145	\$67,373	\$68,795
Average Non-Family Household Size	1.4	1.4	1.4	1.4
Marital Status (2016)				
Population Age 15 Years or Over	36,143	156,482	458,825	758,827
Never Married	12,713 35.2%	58,376 37.3%	173,325 37.8%	286,443 37.7%
Currently Married	15,577 43.1%	63,154 40.4%	179,995 39.2%	302,082 39.8%
Previously Married	7,854 21.7%	34,952 22.3%	105,506 23.0%	170,302 22.4%
Separated	3,498 44.5%	15,649 44.8%	45,968 43.6%	69,173 40.6%
Widowed	1,820 23.2%	8,208 23.5%	25,155 23.8%	42,626 25.0%
Divorced	2,536 32.3%	11,094 31.7%	34,383 32.6%	58,503 34.4%
Educational Attainment (2016)				
Adult Population Age 25 Years or Over	31,415	135,120	396,386	656,358
Elementary (Grade Level 0 to 8)	4,059 12.9%	19,139 14.2%	55,551 14.0%	82,060 12.5%
Some High School (Grade Level 9 to 11)	2,607 8.3%	13,111 9.7%	36,338 9.2%	57,847 8.8%
High School Graduate	7,085 22.6%	33,342 24.7%	105,091 26.5%	176,681 26.9%
Some College	4,623 14.7%	18,092 13.4%	51,083 12.9%	85,314 13.0%
Associate Degree Only	2,313 7.4%	10,787 8.0%	30,469 7.7%	51,888 7.9%
Bachelor Degree Only	7,351 23.4%	27,435 20.3%	76,127 19.2%	129,417 19.7%
Graduate Degree	3,377 10.8%	13,213 9.8%	41,726 10.5%	73,151 11.1%
Any College (Some College or Higher)	17,664 56.2%	69,527 51.5%	199,406 50.3%	339,770 51.8%
College Degree + (Bachelor Degree or Higher)	10,728 34.1%	40,648 30.1%	117,853 29.7%	202,568 30.9%

This report was produced using data from private and government sources deemed to be reliable. The information herein is provided without representation or warranty.

COMPLETE PROFILE

2000-2010 Census, 2016 Estimates with 2021 Projections

Calculated using Weighted Block Centroid from Block Groups



Metro Commercial & Business Brokers, Inc.

Lat/Lon: 40.7348/-73.8734

RFULL9

89-25 Queens Blvd

Elmhurst, NY 11373

	0.5 mi radius		1 mi radius		2 mi radius		3 mi radius	
Housing								
Total Housing Units (2016)	14,951		65,465		195,480		336,474	
Total Housing Units (2010)	14,710		64,496		192,967		331,829	
Historical Annual Growth (2010-2016)	241	0.3%	968	0.3%	2,513	0.2%	4,645	0.2%
Housing Units Occupied (2016)	14,465	96.7%	63,266	96.6%	188,355	96.4%	323,428	96.1%
Housing Units Owner-Occupied	5,051	34.9%	20,169	31.9%	67,912	36.1%	112,547	34.8%
Housing Units Renter-Occupied	9,414	65.1%	43,098	68.1%	120,443	63.9%	210,881	65.2%
Housing Units Vacant (2016)	486	3.4%	2,198	3.5%	7,125	3.8%	13,047	4.0%
Household Size (2016)								
Total Households	14,465		63,266		188,355		323,428	
1 Person Households	3,112	21.5%	14,680	23.2%	46,352	24.6%	83,310	25.8%
2 Person Households	3,747	25.9%	15,511	24.5%	47,204	25.1%	85,528	26.4%
3 Person Households	2,753	19.0%	11,405	18.0%	32,217	17.1%	56,363	17.4%
4 Person Households	2,389	16.5%	10,026	15.8%	28,100	14.9%	47,017	14.5%
5 Person Households	1,274	8.8%	5,657	8.9%	15,997	8.5%	25,159	7.8%
6 Person Households	587	4.1%	2,791	4.4%	8,316	4.4%	12,354	3.8%
7 or More Person Households	603	4.2%	3,197	5.1%	10,170	5.4%	13,697	4.2%
Household Income Distribution (2016)								
HH Income \$200,000 or More	793	5.5%	2,669	4.2%	9,329	5.0%	16,115	5.0%
HH Income \$150,000 to \$199,999	775	5.4%	2,918	4.6%	10,018	5.3%	18,381	5.7%
HH Income \$125,000 to \$149,999	864	6.0%	2,953	4.7%	9,702	5.2%	17,596	5.4%
HH Income \$100,000 to \$124,999	1,230	8.5%	5,109	8.1%	15,530	8.2%	27,039	8.4%
HH Income \$75,000 to \$99,999	1,757	12.1%	7,752	12.3%	24,212	12.9%	42,329	13.1%
HH Income \$50,000 to \$74,999	2,682	18.5%	11,373	18.0%	34,330	18.2%	57,683	17.8%
HH Income \$35,000 to \$49,999	1,756	12.1%	8,591	13.6%	25,139	13.3%	41,490	12.8%
HH Income \$25,000 to \$34,999	1,205	8.3%	6,289	9.9%	18,096	9.6%	29,913	9.2%
HH Income \$15,000 to \$24,999	1,470	10.2%	6,974	11.0%	19,623	10.4%	34,020	10.5%
HH Income \$10,000 to \$14,999	776	5.4%	3,287	5.2%	8,404	4.5%	14,373	4.4%
HH Income Under \$10,000	1,157	8.0%	5,351	8.5%	13,973	7.4%	24,489	7.6%
Household Vehicles (2016)								
Households 0 Vehicles Available	6,610	45.7%	30,764	48.6%	86,238	45.8%	148,780	46.0%
Households 1 Vehicle Available	5,832	40.3%	24,719	39.1%	76,301	40.5%	129,004	39.9%
Households 2 Vehicles Available	1,661	11.5%	6,194	9.8%	20,631	11.0%	36,906	11.4%
Households 3 or More Vehicles Available	362	2.5%	1,590	2.5%	5,185	2.8%	8,737	2.7%
Total Vehicles Available	10,466		42,331		135,012		232,021	
Average Vehicles per Household	0.7		0.7		0.7		0.7	
Owner-Occupied Household Vehicles	5,259	50.3%	20,649	48.8%	71,879	53.2%	121,310	52.3%
Average Vehicles per Owner-Occupied Household	1.0		1.0		1.1		1.1	
Renter-Occupied Household Vehicles	5,207	49.7%	21,682	51.2%	63,134	46.8%	110,710	47.7%
Average Vehicles per Renter-Occupied Household	0.6		0.5		0.5		0.5	
Travel Time (2010)								
Worker Base Age 16 years or Over	19,967		83,584		250,099		411,289	
Travel to Work in 14 Minutes or Less	1,498	7.5%	6,207	7.4%	20,372	8.1%	34,781	8.5%
Travel to Work in 15 to 29 Minutes	3,052	15.3%	12,216	14.6%	40,887	16.3%	71,516	17.4%
Travel to Work in 30 to 59 Minutes	10,452	52.3%	41,456	49.6%	117,340	46.9%	193,491	47.0%
Travel to Work in 60 Minutes or More	4,553	22.8%	21,572	25.8%	64,536	25.8%	100,287	24.4%
Work at Home	412	2.1%	2,134	2.6%	6,964	2.8%	11,214	2.7%
Average Minutes Travel to Work	42.8		43.0		41.8		40.9	

This report was produced using data from private and government sources deemed to be reliable. The information herein is provided without representation or warranty.

COMPLETE PROFILE

2000-2010 Census, 2016 Estimates with 2021 Projections

Calculated using Weighted Block Centroid from Block Groups



Metro Commercial & Business Brokers, Inc.

Lat/Lon: 40.7348/-73.8734

RFULL9

89-25 Queens Blvd Elmhurst, NY 11373	0.5 mi radius	1 mi radius	2 mi radius	3 mi radius
Transportation To Work (2010)				
Worker Base Age 16 years or Over	19,967	83,584	250,099	411,289
Drive to Work Alone	4,579 22.9%	18,867 22.6%	59,072 23.6%	102,832 25.0%
Drive to Work in Carpool	1,051 5.3%	4,546 5.4%	14,187 5.7%	24,455 5.9%
Travel to Work by Public Transportation	12,433 62.3%	51,690 61.8%	150,912 60.3%	240,571 58.5%
Drive to Work on Motorcycle	1 -	70 0.1%	99 -	271 0.1%
Bicycle to Work	52 0.3%	321 0.4%	1,295 0.5%	1,985 0.5%
Walk to Work	1,266 6.3%	5,525 6.6%	16,286 6.5%	27,568 6.7%
Other Means	173 0.9%	432 0.5%	1,286 0.5%	2,393 0.6%
Work at Home	412 2.1%	2,134 2.6%	6,964 2.8%	11,214 2.7%
Daytime Demographics (2016)				
Total Businesses	1,163	4,119	13,727	27,268
Total Employees	18,699	42,096	110,222	231,452
Company Headquarter Businesses	- -	5 0.1%	18 0.1%	56 0.2%
Company Headquarter Employees	- -	122 0.3%	1,907 1.7%	10,107 4.4%
Employee Population per Business	16.1 to 1	10.2 to 1	8.0 to 1	8.5 to 1
Residential Population per Business	36.7 to 1	45.7 to 1	40.5 to 1	33.6 to 1
Adj. Daytime Demographics Age 16 Years or Over	32,559	102,441	279,732	512,174
Labor Force				
Labor Population Age 16 Years or Over (2016)	35,764	154,767	453,708	750,445
Labor Force Total Males (2016)	17,108 47.8%	75,847 49.0%	226,037 49.8%	369,284 49.2%
Male Civilian Employed	11,982 70.0%	52,969 69.8%	163,536 72.3%	264,208 71.5%
Male Civilian Unemployed	349 2.0%	1,504 2.0%	4,834 2.1%	8,386 2.3%
Males in Armed Forces	7 -	10 -	34 -	80 -
Males Not in Labor Force	4,770 27.9%	21,363 28.2%	57,633 25.5%	96,610 26.2%
Labor Force Total Females (2016)	18,656 52.2%	78,920 51.0%	227,672 50.2%	381,162 50.8%
Female Civilian Employed	9,915 53.1%	41,437 52.5%	120,622 53.0%	205,416 53.9%
Female Civilian Unemployed	271 1.5%	1,254 1.6%	4,235 1.9%	7,331 1.9%
Females in Armed Forces	- -	6 -	6 -	19 -
Females Not in Labor Force	8,470 45.4%	36,224 45.9%	102,808 45.2%	168,395 44.2%
Unemployment Rate	1.7%	1.8%	2.0%	2.1%
Labor Force Growth (2010-2016)	1,707 8.5%	9,087 10.7%	28,389 11.1%	48,564 11.5%
Male Labor Force Growth (2010-2016)	963 8.7%	4,105 8.4%	15,823 10.7%	26,429 11.1%
Female Labor Force Growth (2010-2016)	744 8.1%	4,981 13.7%	12,566 11.6%	22,134 12.1%
Occupation (2010)				
Occupation Population Age 16 Years or Over	20,190	85,319	255,769	421,061
Occupation Total Males	11,019 54.6%	48,864 57.3%	147,713 57.8%	237,779 56.5%
Occupation Total Females	9,171 45.4%	36,455 42.7%	108,056 42.2%	183,282 43.5%
Management, Business, Financial Operations	2,670 13.2%	9,384 11.0%	28,540 11.2%	49,552 11.8%
Professional, Related	3,263 16.2%	12,810 15.0%	41,592 16.3%	74,669 17.7%
Service	5,190 25.7%	24,662 28.9%	68,814 26.9%	106,854 25.4%
Sales, Office	5,073 25.1%	20,107 23.6%	59,291 23.2%	99,390 23.6%
Farming, Fishing, Forestry	24 0.1%	61 0.1%	235 0.1%	393 0.1%
Construction, Extraction, Maintenance	1,362 6.7%	7,012 8.2%	24,763 9.7%	39,073 9.3%
Production, Transport, Material Moving	2,608 12.9%	11,282 13.2%	32,534 12.7%	51,130 12.1%
White Collar Workers	11,006 54.5%	42,301 49.6%	129,423 50.6%	223,611 53.1%
Blue Collar Workers	9,184 45.5%	43,018 50.4%	126,346 49.4%	197,450 46.9%

This report was produced using data from private and government sources deemed to be reliable. The information herein is provided without representation or warranty.

COMPLETE PROFILE

2000-2010 Census, 2016 Estimates with 2021 Projections

Calculated using Weighted Block Centroid from Block Groups



Metro Commercial & Business Brokers, Inc.

Lat/Lon: 40.7348/-73.8734

RFULL9

89-25 Queens Blvd		0.5 mi radius		1 mi radius		2 mi radius		3 mi radius	
Elmhurst, NY 11373									
Units In Structure (2010)									
Total Units		13,953		61,241		181,652		310,348	
1 Detached Unit		1,438	10.3%	5,081	8.3%	16,764	9.2%	27,898	9.0%
1 Attached Unit		739	5.3%	4,821	7.9%	16,638	9.2%	27,198	8.8%
2 Units		1,712	12.3%	7,157	11.7%	28,533	15.7%	54,750	17.6%
3 to 4 Units		3,097	22.2%	9,823	16.0%	26,484	14.6%	43,081	13.9%
5 to 9 Units		886	6.3%	2,857	4.7%	8,640	4.8%	24,498	7.9%
10 to 19 Units		379	2.7%	1,904	3.1%	6,738	3.7%	12,611	4.1%
20 to 49 Units		912	6.5%	5,740	9.4%	20,232	11.1%	34,583	11.1%
50 or More Units		4,752	34.1%	23,640	38.6%	57,045	31.4%	84,503	27.2%
Mobile Home or Trailer		37	0.3%	195	0.3%	466	0.3%	968	0.3%
Other Structure		2	-	22	-	114	0.1%	257	0.1%
Homes Built By Year (2010)									
Homes Built 2005 or later		447	3.2%	1,396	2.3%	4,227	2.3%	7,119	2.3%
Homes Built 2000 to 2004		333	2.4%	1,312	2.1%	4,175	2.3%	6,715	2.2%
Homes Built 1990 to 1999		622	4.5%	2,347	3.8%	6,800	3.7%	11,386	3.7%
Homes Built 1980 to 1989		796	5.7%	3,451	5.6%	8,610	4.7%	14,333	4.6%
Homes Built 1970 to 1979		1,198	8.6%	4,824	7.9%	13,528	7.4%	22,644	7.3%
Homes Built 1960 to 1969		2,765	19.8%	10,530	17.2%	27,116	14.9%	42,420	13.7%
Homes Built 1950 to 1959		2,454	17.6%	11,538	18.8%	34,251	18.9%	54,535	17.6%
Homes Built 1940 to 1949		1,621	11.6%	9,049	14.8%	25,997	14.3%	44,047	14.2%
Homes Built Before 1939		3,716	26.6%	16,831	27.5%	56,956	31.4%	107,195	34.5%
Median Age of Homes		56.3 yrs		58.1 yrs		59.4 yrs		60.3 yrs	
Home Values (2010)									
Owner Specified Housing Units		4,853		19,529		65,600		108,511	
Home Values \$1,000,000 or More		80	1.6%	388	2.0%	1,707	2.6%	3,047	2.8%
Home Values \$750,000 to \$999,999		597	12.3%	1,805	9.2%	5,511	8.4%	8,722	8.0%
Home Values \$500,000 to \$749,999		1,443	29.7%	5,485	28.1%	18,146	27.7%	31,211	28.8%
Home Values \$400,000 to \$499,999		378	7.8%	2,159	11.1%	7,208	11.0%	12,906	11.9%
Home Values \$300,000 to \$399,999		433	8.9%	2,196	11.2%	8,000	12.2%	12,872	11.9%
Home Values \$250,000 to \$299,999		463	9.5%	1,526	7.8%	4,601	7.0%	7,373	6.8%
Home Values \$200,000 to \$249,999		308	6.3%	1,485	7.6%	5,801	8.8%	9,392	8.7%
Home Values \$175,000 to \$199,999		275	5.7%	842	4.3%	2,483	3.8%	3,968	3.7%
Home Values \$150,000 to \$174,999		235	4.8%	955	4.9%	3,346	5.1%	5,050	4.7%
Home Values \$125,000 to \$149,999		119	2.4%	558	2.9%	1,638	2.5%	2,615	2.4%
Home Values \$100,000 to \$124,999		199	4.1%	691	3.5%	2,325	3.5%	3,614	3.3%
Home Values \$90,000 to \$99,999		32	0.7%	223	1.1%	691	1.1%	1,124	1.0%
Home Values \$80,000 to \$89,999		56	1.2%	374	1.9%	861	1.3%	1,246	1.1%
Home Values \$70,000 to \$79,999		68	1.4%	186	1.0%	590	0.9%	918	0.8%
Home Values \$60,000 to \$69,999		42	0.9%	166	0.8%	573	0.9%	968	0.9%
Home Values \$50,000 to \$59,999		43	0.9%	130	0.7%	433	0.7%	770	0.7%
Home Values \$35,000 to \$49,999		25	0.5%	127	0.6%	573	0.9%	927	0.9%
Home Values \$25,000 to \$34,999		19	0.4%	65	0.3%	484	0.7%	727	0.7%
Home Values \$10,000 to \$24,999		35	0.7%	118	0.6%	482	0.7%	851	0.8%
Home Values Under \$10,000		3	0.1%	49	0.2%	148	0.2%	211	0.2%
Owner-Occupied Median Home Value		\$437,948		\$421,119		\$415,267		\$426,637	
Renter-Occupied Median Rent		\$1,151		\$1,112		\$1,134		\$1,116	

This report was produced using data from private and government sources deemed to be reliable. The information herein is provided without representation or warranty.

COMPLETE PROFILE

2000-2010 Census, 2016 Estimates with 2021 Projections

Calculated using Weighted Block Centroid from Block Groups



Metro Commercial & Business Brokers, Inc.

Lat/Lon: 40.7348/-73.8734

RFULL9

89-25 Queens Blvd

Elmhurst, NY 11373

	0.5 mi radius	1 mi radius	2 mi radius	3 mi radius
Total Annual Consumer Expenditure (2016)				
Total Household Expenditure	\$856 M	\$3.43 B	\$10.7 B	\$18.5 B
Total Non-Retail Expenditure	\$464 M	\$1.86 B	\$5.79 B	\$10.0 B
Total Retail Expenditure	\$392 M	\$1.57 B	\$4.90 B	\$8.48 B
Apparel	\$30.5 M	\$122 M	\$380 M	\$657 M
Contributions	\$36.0 M	\$141 M	\$451 M	\$788 M
Education	\$32.8 M	\$129 M	\$406 M	\$709 M
Entertainment	\$47.9 M	\$191 M	\$598 M	\$1.04 B
Food and Beverages	\$127 M	\$512 M	\$1.59 B	\$2.74 B
Furnishings and Equipment	\$29.3 M	\$117 M	\$366 M	\$636 M
Gifts	\$21.0 M	\$82.6 M	\$262 M	\$457 M
Health Care	\$68.3 M	\$277 M	\$856 M	\$1.48 B
Household Operations	\$24.5 M	\$96.5 M	\$305 M	\$530 M
Miscellaneous Expenses	\$12.7 M	\$51.2 M	\$159 M	\$275 M
Personal Care	\$11.2 M	\$45.0 M	\$140 M	\$243 M
Personal Insurance	\$6.31 M	\$24.8 M	\$78.5 M	\$137 M
Reading	\$1.90 M	\$7.59 M	\$23.7 M	\$41.2 M
Shelter	\$176 M	\$706 M	\$2.20 B	\$3.81 B
Tobacco	\$5.28 M	\$21.8 M	\$66.3 M	\$114 M
Transportation	\$160 M	\$642 M	\$1.99 B	\$3.45 B
Utilities	\$65.2 M	\$264 M	\$816 M	\$1.41 B
Monthly Household Consumer Expenditure (2016)				
Total Household Expenditure	\$4,932	\$4,518	\$4,729	\$4,772
Total Non-Retail Expenditure	\$2,675 54.2%	\$2,445 54.1%	\$2,563 54.2%	\$2,586 54.2%
Total Retail Expenditures	\$2,257 45.8%	\$2,073 45.9%	\$2,166 45.8%	\$2,186 45.8%
Apparel	\$176 3.6%	\$161 3.6%	\$168 3.6%	\$169 3.5%
Contributions	\$208 4.2%	\$186 4.1%	\$200 4.2%	\$203 4.3%
Education	\$189 3.8%	\$169 3.7%	\$180 3.8%	\$183 3.8%
Entertainment	\$276 5.6%	\$252 5.6%	\$265 5.6%	\$267 5.6%
Food and Beverages	\$732 14.8%	\$675 14.9%	\$702 14.8%	\$706 14.8%
Furnishings and Equipment	\$169 3.4%	\$153 3.4%	\$162 3.4%	\$164 3.4%
Gifts	\$121 2.5%	\$109 2.4%	\$116 2.4%	\$118 2.5%
Health Care	\$394 8.0%	\$365 8.1%	\$379 8.0%	\$382 8.0%
Household Operations	\$141 2.9%	\$127 2.8%	\$135 2.9%	\$137 2.9%
Miscellaneous Expenses	\$73 1.5%	\$67 1.5%	\$70 1.5%	\$71 1.5%
Personal Care	\$65 1.3%	\$59 1.3%	\$62 1.3%	\$63 1.3%
Personal Insurance	\$36 0.7%	\$33 0.7%	\$35 0.7%	\$35 0.7%
Reading	\$11 0.2%	\$10 0.2%	\$10 0.2%	\$11 0.2%
Shelter	\$1,015 20.6%	\$930 20.6%	\$973 20.6%	\$983 20.6%
Tobacco	\$30 0.6%	\$29 0.6%	\$29 0.6%	\$29 0.6%
Transportation	\$920 18.7%	\$845 18.7%	\$883 18.7%	\$889 18.6%
Utilities	\$376 7.6%	\$348 7.7%	\$361 7.6%	\$363 7.6%

This report was produced using data from private and government sources deemed to be reliable. The information herein is provided without representation or warranty.